

Evolve Switchhub APP UI Guide

- [How to rename APP buttons](#) 1
- [How to Dim Touch Button LED & the Glass Status LED](#) 2
- [How to set Multi-Control Association](#) 3
- [How to set touch button to momentary mode](#) 5
- [How to Add and Set Switch CMD Values](#) 7

How To Rename App Buttons

1. Setting > Button rename > Type the preferred button name

Note: Please always refresh the APP before changing settings to ensure the APP is connected to the internet.

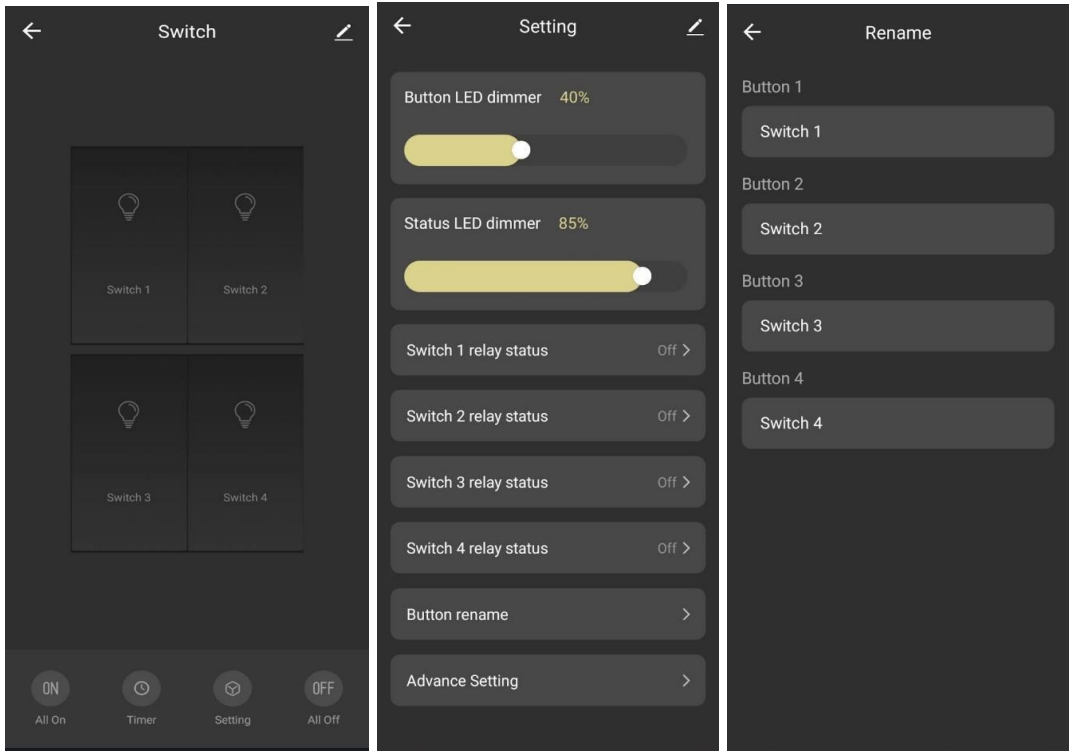

How To Dim Touch Button Led & The Glass Status Led

1. Setting > Slide to adjust dim level 0~100

Note: Please always refresh the APP before changing settings to ensure the APP is connected to the internet.

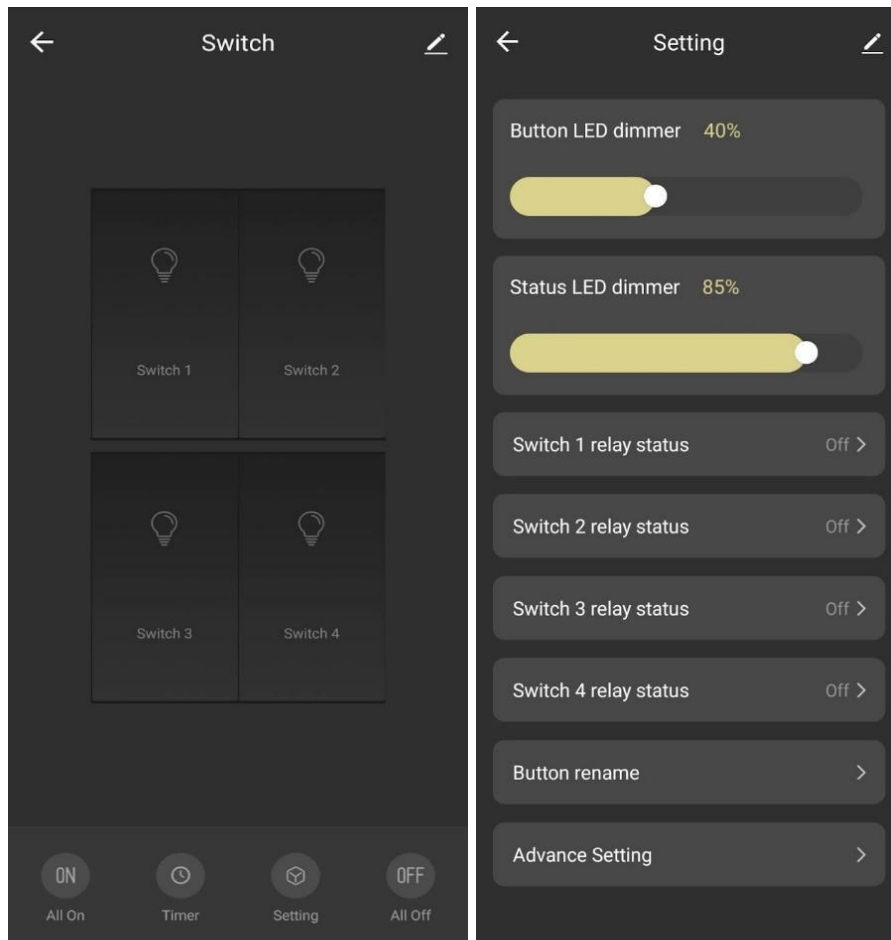

How To Set Multi-Control Association

Before setting please review possible conflicts in saved automations from user and Advance setting from CMD values, paired S2S Switch to Switch Wired Multi-Button Association.

1. Got to the pencil icon located at the top right corner of the screen
2. Select Multi-Control Association
3. Select the intended button > + Link with Switch > Open the intended Switch > Select the intended button.

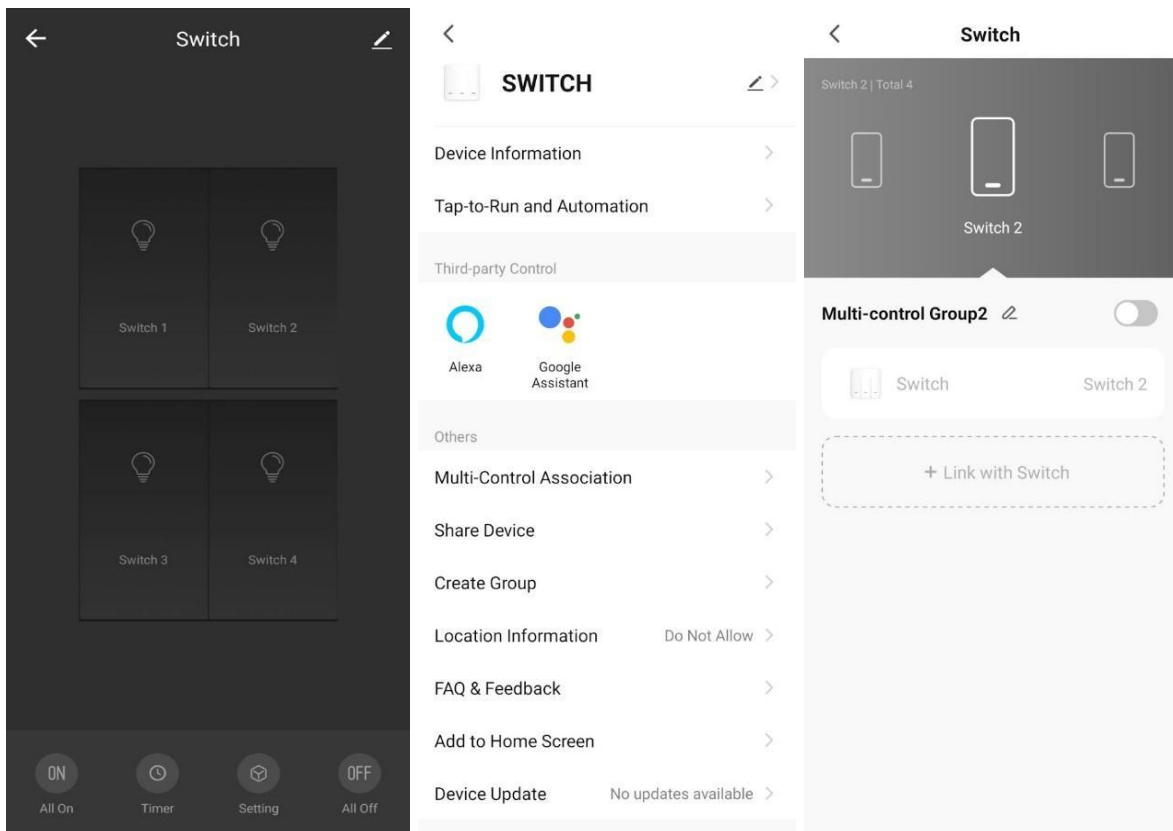

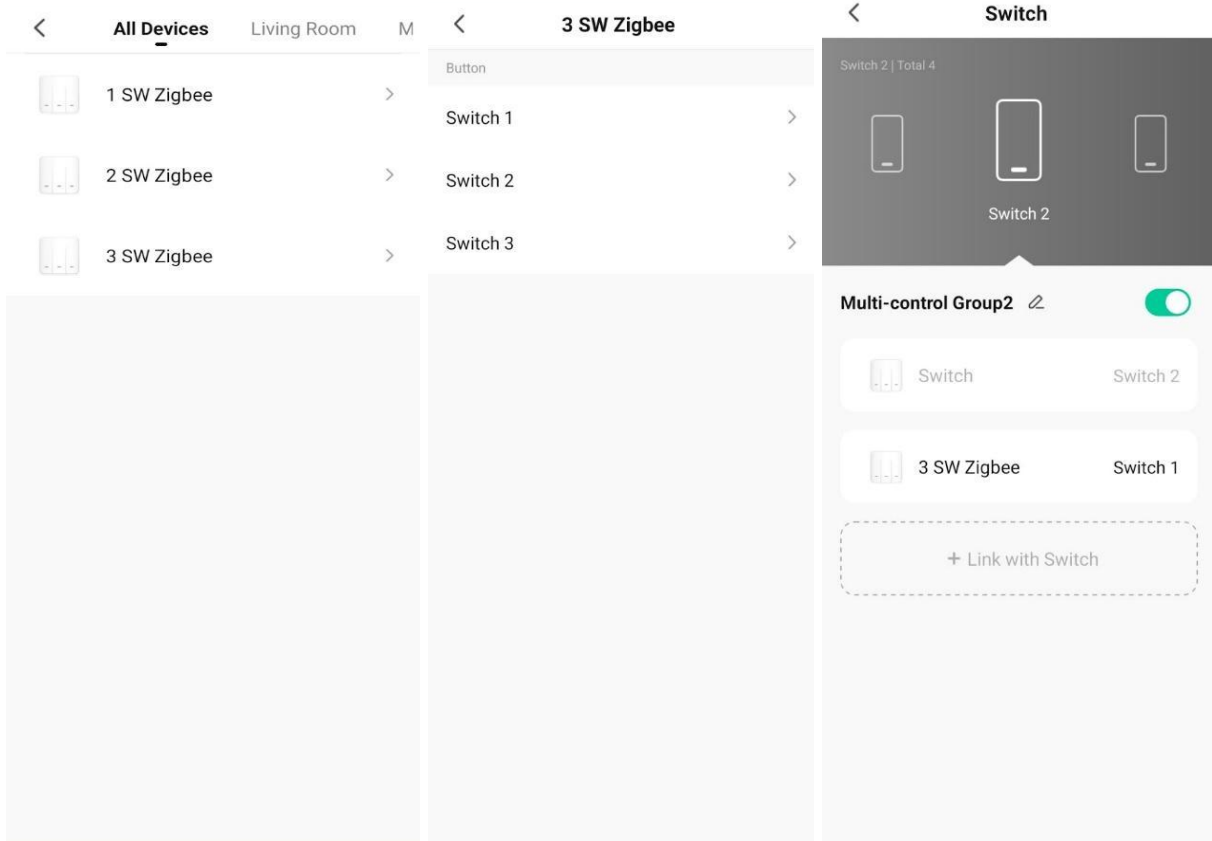

How To Set Touch Button To Momentary Mode

Momentary mode changes the operational character of the touch button into a momentary touch switch. This means the button will only turn on if pressed, then off when released.

IMPORTANT NOTICE: This setting is for advanced use cases. Please consult a professional if not sure. Before setting please review possible conflicts in saved automations from user and Advance setting from CMD values, paired S2S Switch to Switch Wired Multi-Button Association.

1. Setting > Advance Setting > Enter Password 001001 > Button mode > Toggle ON
(Momentary mode active)

2. To switch back to Normal switch mode, please toggle OFF.

Note: Please always refresh the APP before changing settings to ensure the APP is connected to the internet.

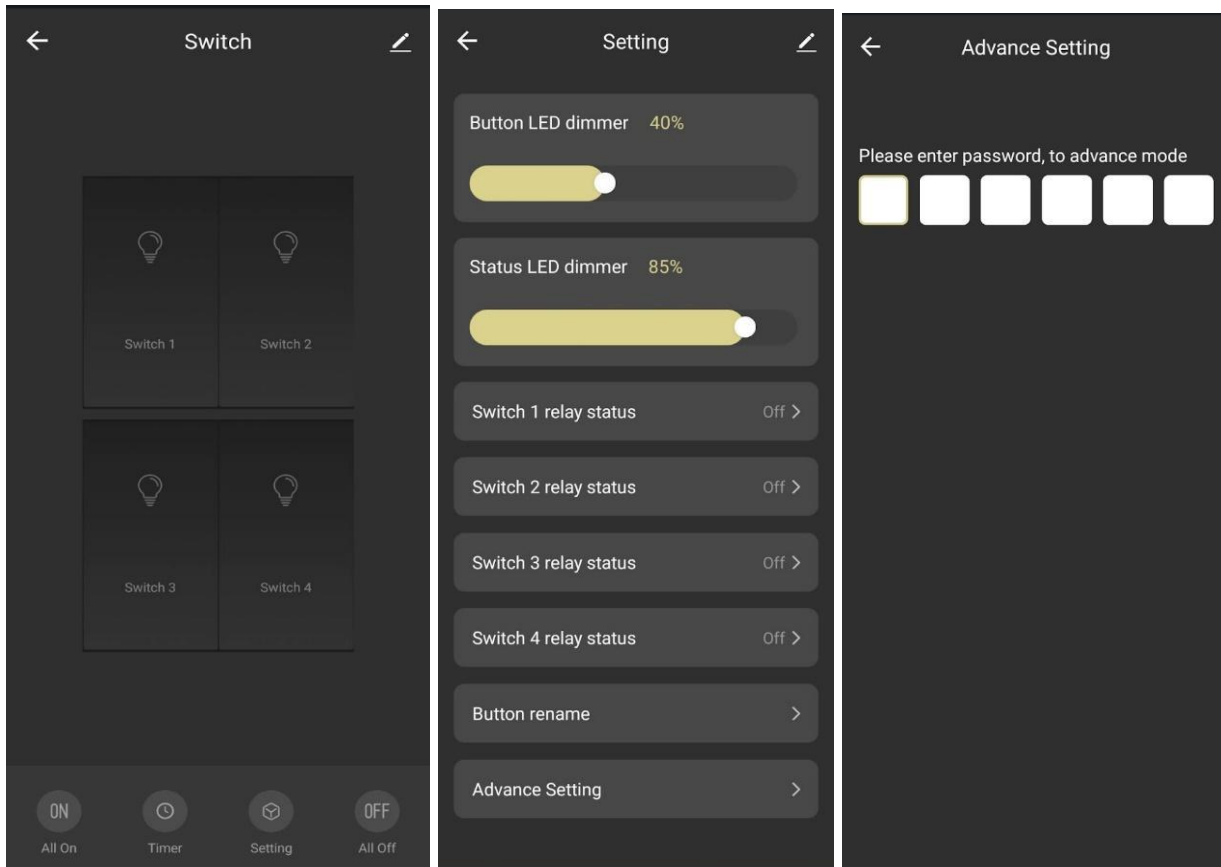

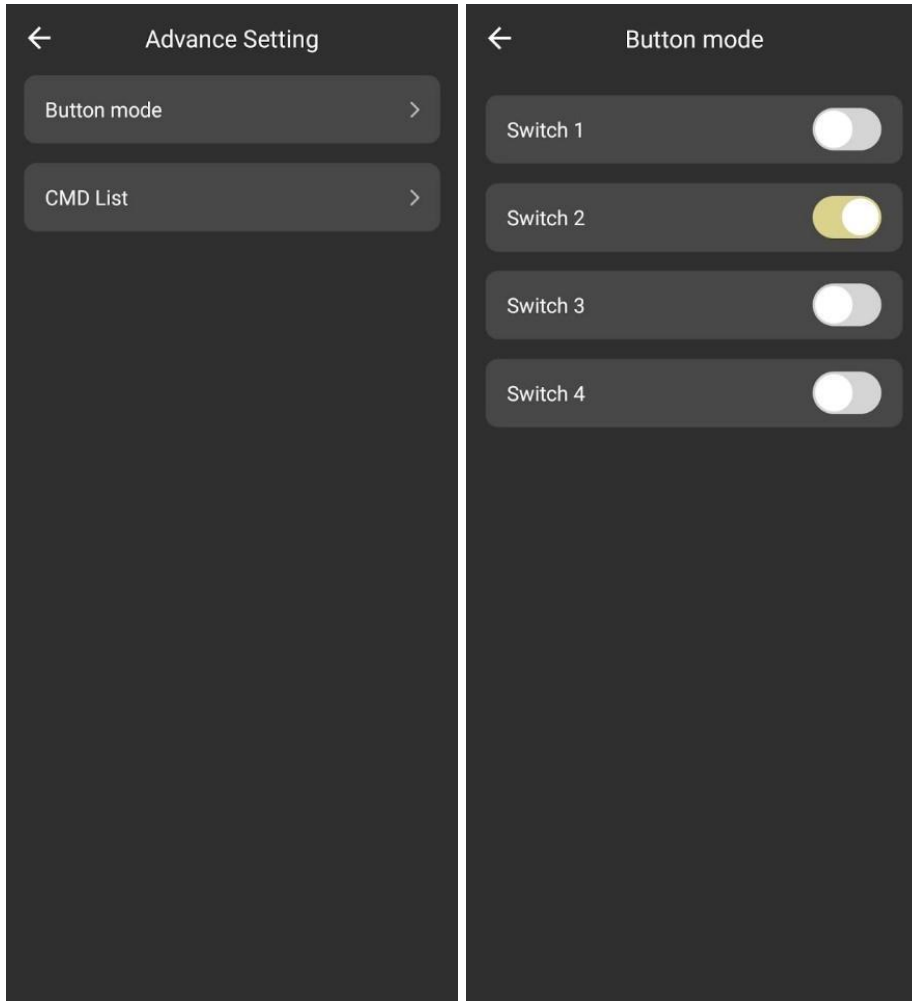

How To Add And Set Switch Cmd Values

CMD is an advanced setting to customize switch usage beyond the normal operational limits of switch. More CMD settings will be added in future versions.

List of CMD advance setting:

CMD 1	Reverse relay for buttons 1-8
CMD 2	Reverse relay for buttons 9-12
CMD 3	Auto off, off delay for buttons 1-3
CMD 4	Auto off, off delay for buttons 4-6
CMD 5	Auto off, off delay for buttons 7-9
CMD 6	Auto off, off delay for buttons 10-12
CMD 7	LED index for buttons 1-4
CMD 8	LED Index for buttons 4-8
CMD 9	LED Index for buttons 7-9
CMD 10	Disable Touch for buttons 1-8
CMD 11	Disable Touch for buttons 9-12
CMD 12	Off LED brightness level for buttons 1-8
CMD 13	Off LED brightness level for buttons 9-12
CMD 14	On LED brightness level for buttons 1-8
CMD 15	On LED brightness level for buttons 9-12
CMD 16	Status LED display modes

CMD value calculator website: <https://novahome.ph/cmd/>

IMPORTANT NOTICE: This setting is for advanced use cases. Please consult a professional if not sure. Before setting please review possible conflicts in saved automations from user and Advance setting from CMD values, paired S2S Switch to Switch Wired Multi-Button Association.

1. Add Command: Setting > Advance Setting > Enter Password 001001 > CMD List > Add Command > input Command Number > Confirm

2. Add Value: Select the Pencil icon > Input desired Value > Confirm

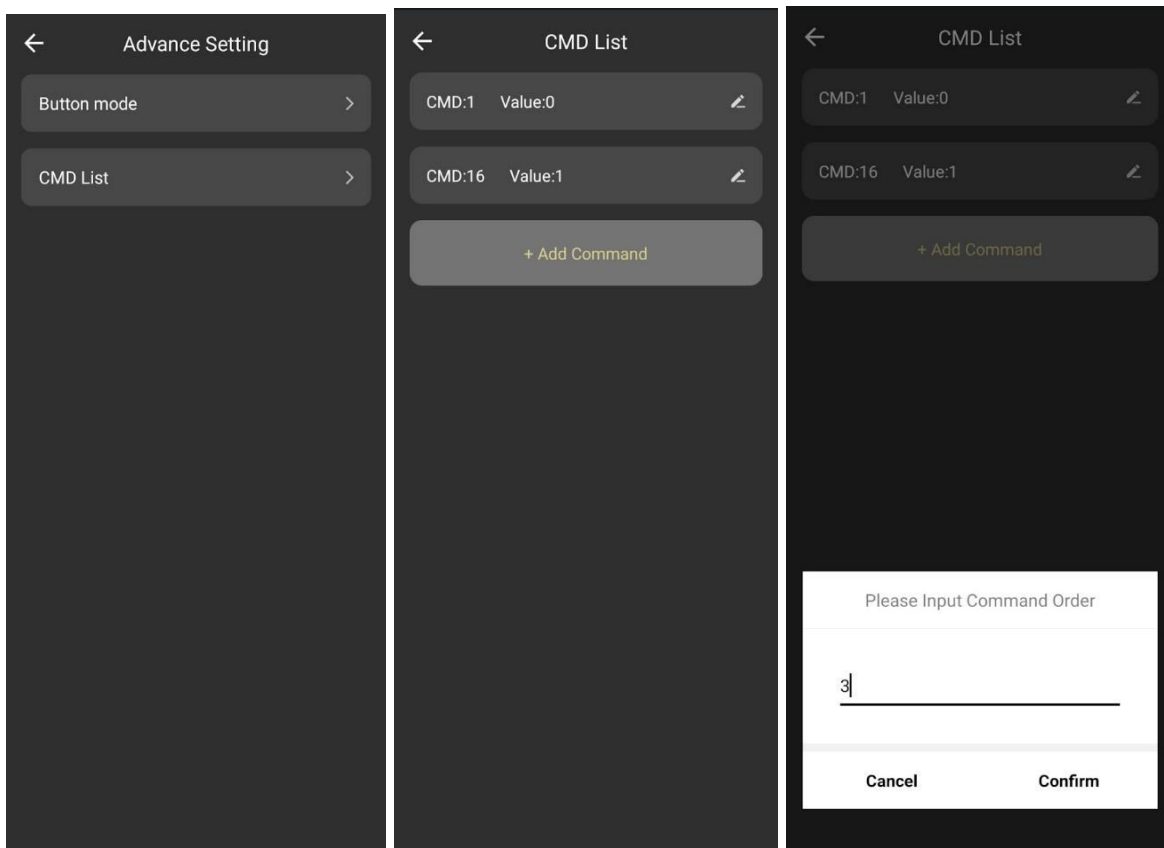
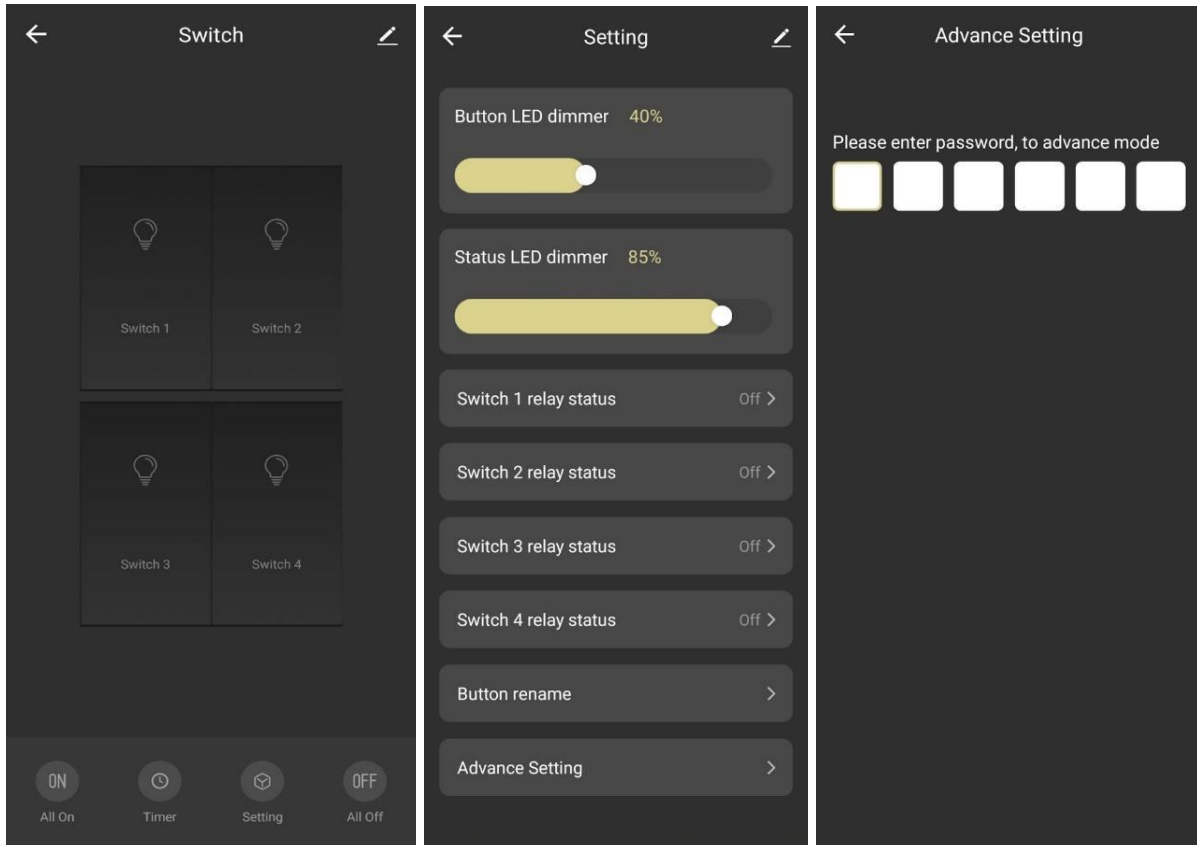

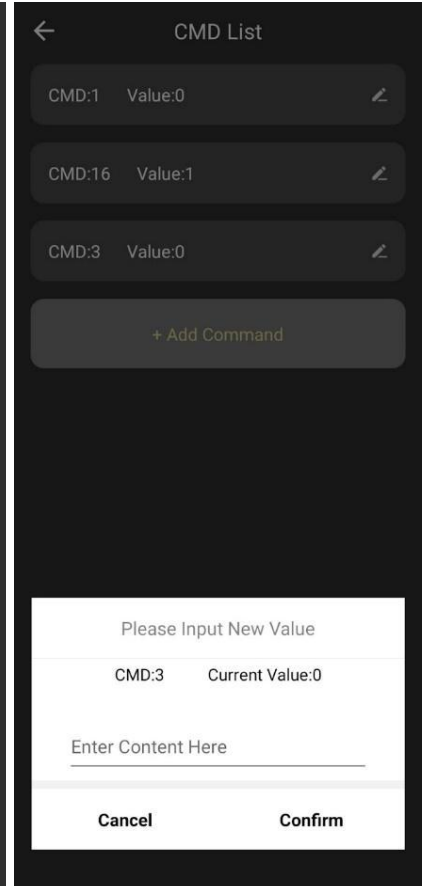
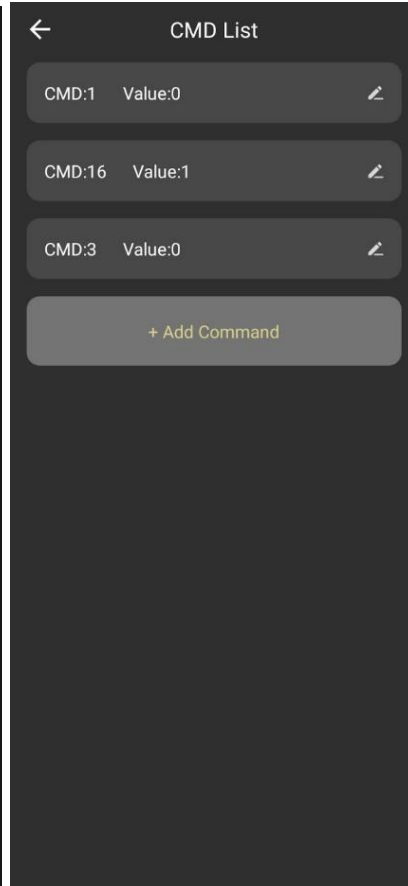
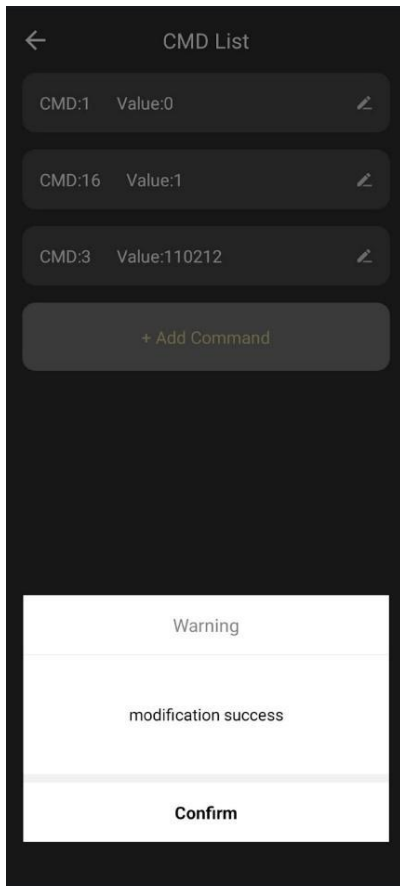

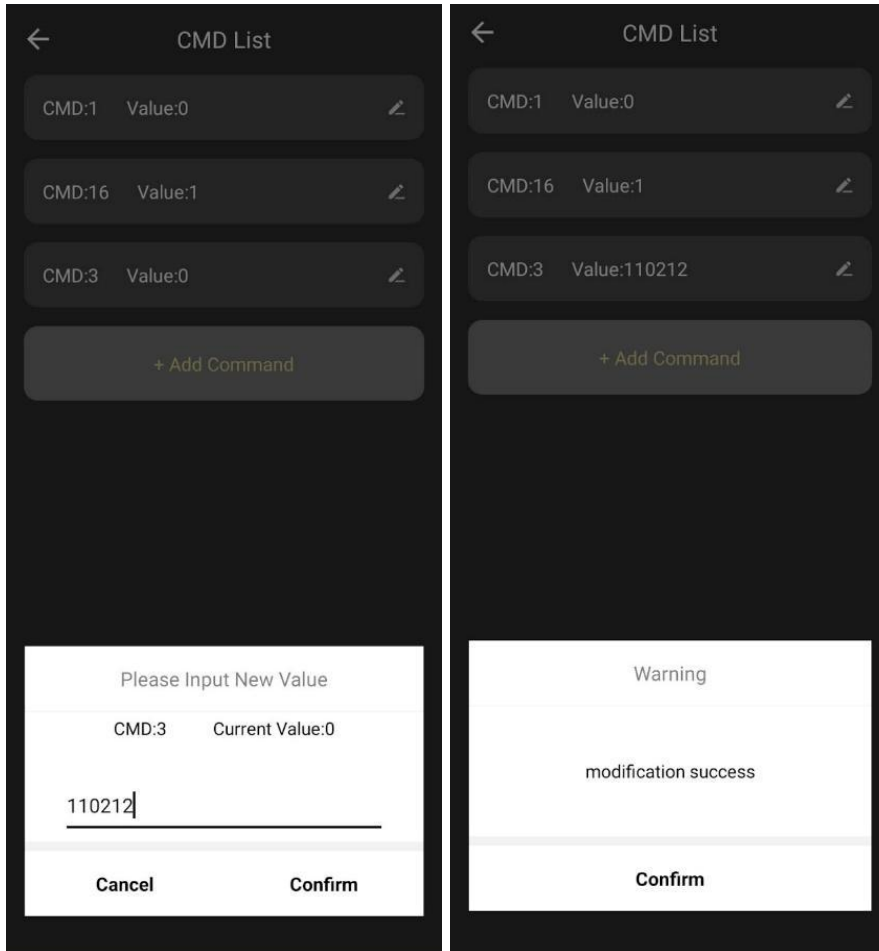

CMD value calculator website: <https://novahome.ph/cmd/>