

Smart Touch Panel Pairing-Unpairing-Factory reset

PRODUCT DETAILS	2
PRODUCT DIMENSIONS	4
IMPORTANT!!! Wall level finish and wall box mounting position:	5
SMART TOUCH PANEL PAIRING/UNPAIRING TO SWITCHUB/SMART HUB/GATEWAY	6
Pairing/Unpairing	6
Factory reset	7

PRODUCT DETAILS

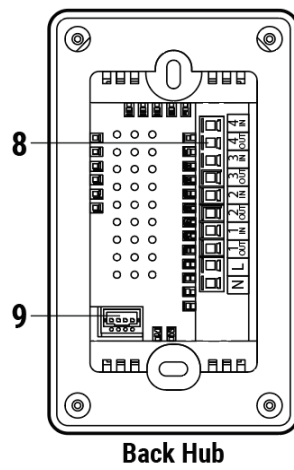
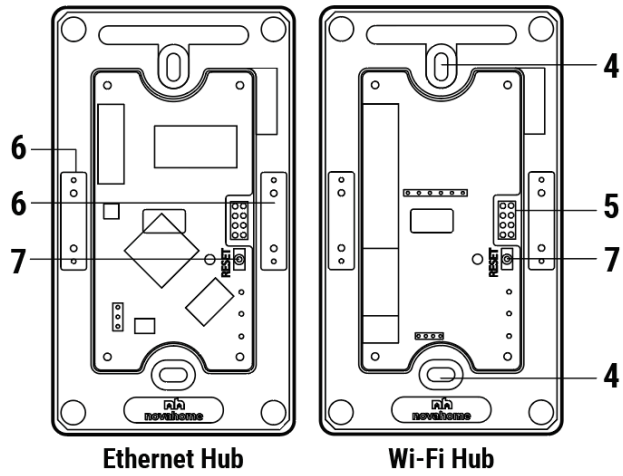
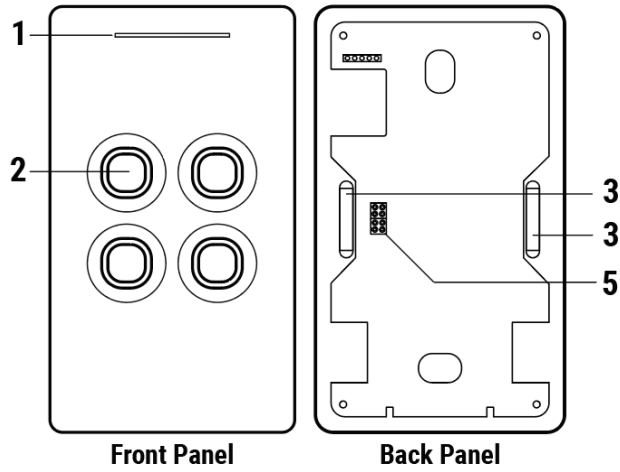

Labels:

1. Dimmable Status Led
Red - Offline
Blue - Online
2. Dimmable Touch Buttons
Red - ON
Blue - OFF/Standby
3. Magnet
4. Screw Hole
5. Pin
6. Metal Plate
7. Reset Button
8. Wire Terminal
9. Communication Port

Accessories:

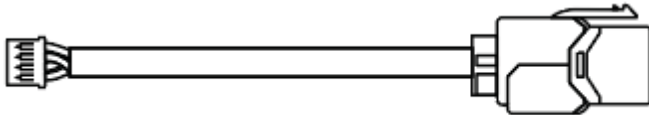

Communication Cable



Wire Connectors

PRODUCT DIMENSIONS

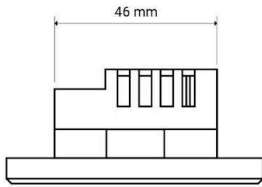

TOP VIEW

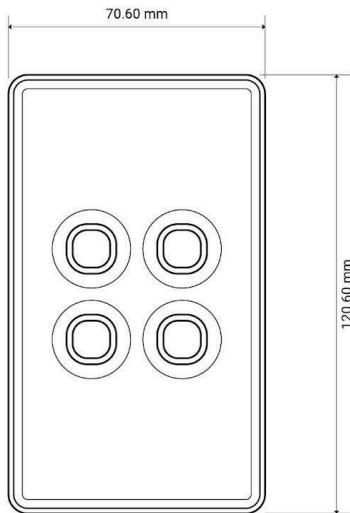

FRONT VIEW

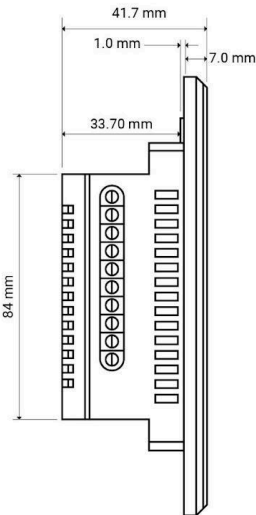

SIDE VIEW

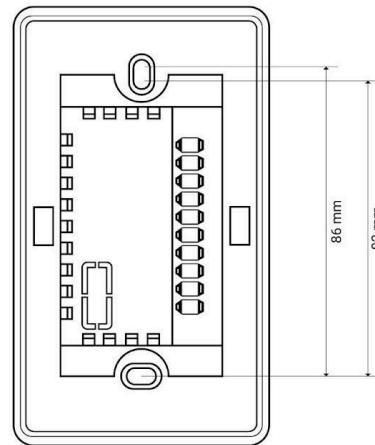

BACK VIEW

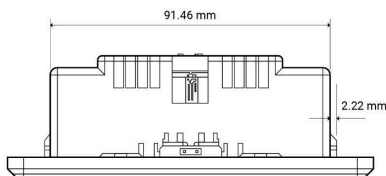

TOP VIEW

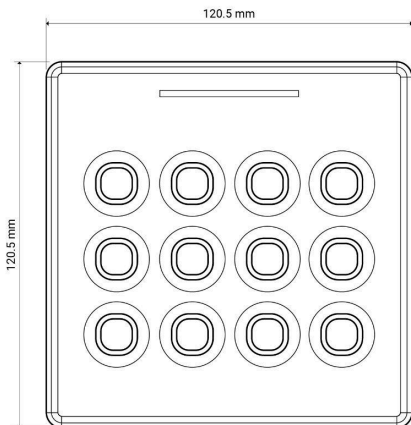

FRONT VIEW

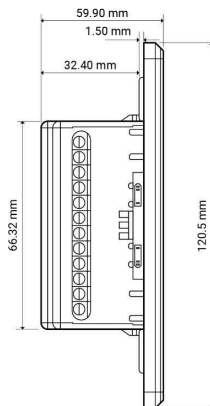

SIDE VIEW

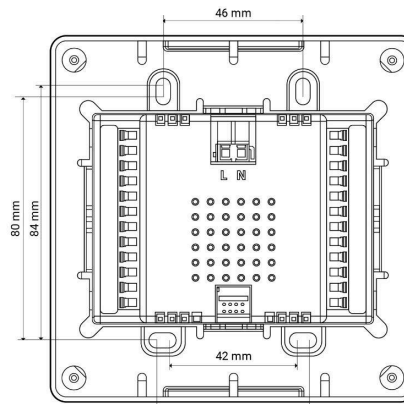

BACK VIEW

IMPORTANT!!! Wall level finish and wall box mounting position:

Wall surface where the Switchhub will be Installed needs to be evenly flat. This is to ensure that the touch panel magnetic will 100% attach properly to the surface of the Switchhub.

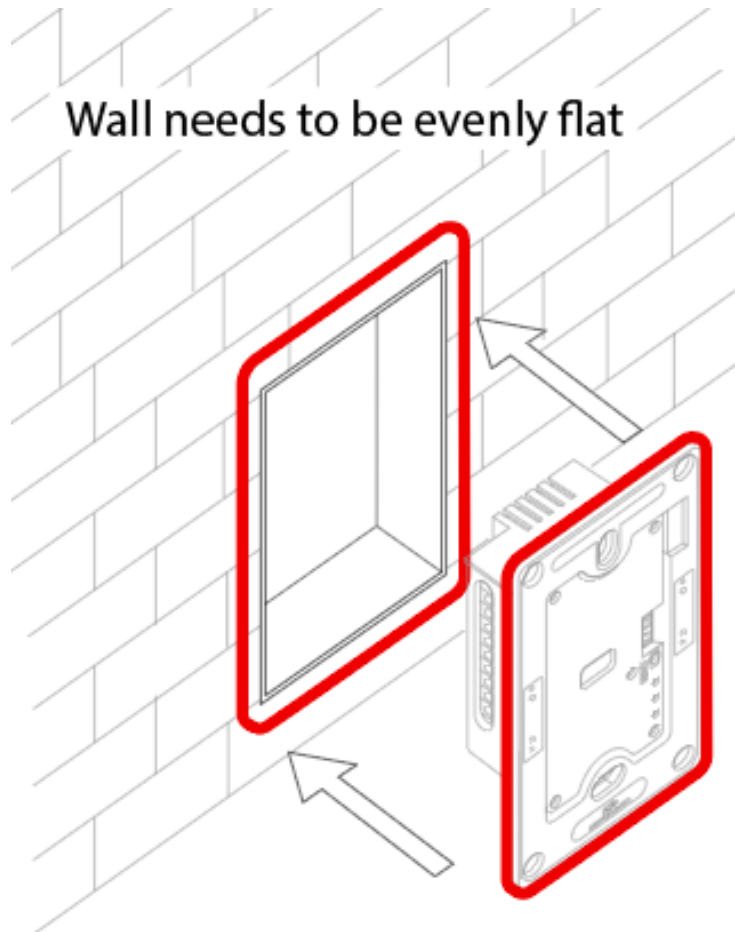

SMART TOUCH PANEL PAIRING/UNPAIRING TO SWITCHUB/SMART HUB/GATEWAY

Pairing/Unpairing

1. Set the Switchub/Smart hub/Gateway to pairing mode

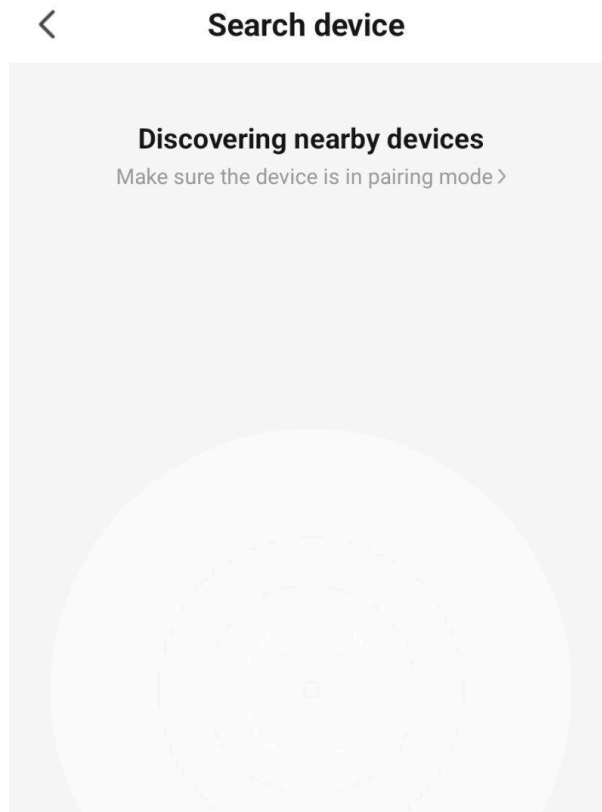

2. Detach the smart touch panel from the main Hub. Pull by hand to detach.

3. Attach the smart touch panel back to the main Hub to power ON.

4. Immediately within 5 secs from power ON, press and hold any button until the status led flashes that it's now on pairing mode.

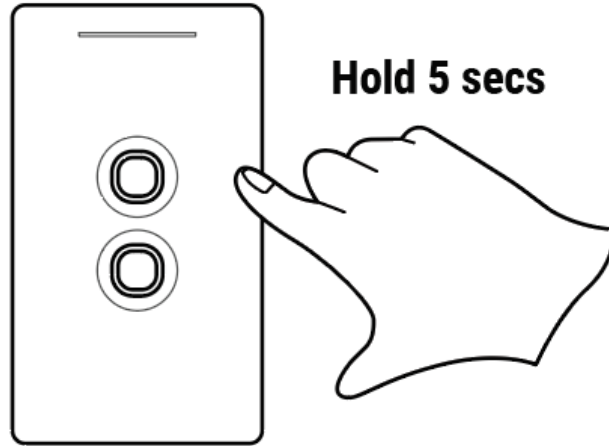

Factory reset

1. Detach the smart touch panel from the main Hub. Pull by hand to detach.
2. Attach the smart touch panel back to the main hub to power ON.
3. Immediately within 5 secs from power ON, press buttons 6 times quickly until the status led flashes. Pause 2 seconds.

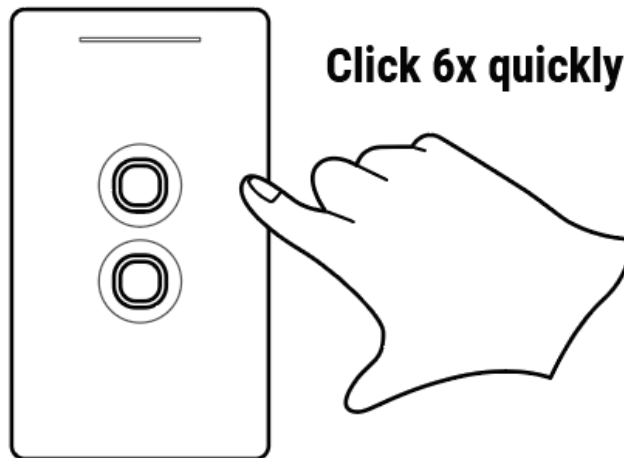

4. Press & hold the same button for 3 seconds.

Note: Use the same button.